

NOTE:
 THE SITE PLAN AND ALL INFORMATION HEREIN IS PRELIMINARY
 AND SUBJECT TO CHANGE AND IS NEITHER A REPRESENTATION,
 WARRANTY, OR AGREEMENT. NEITHER IS THERE ANY
 REPRESENTATION, WARRANTY, OR AGREEMENT THAT PROSPECTIVE
 TENANTS SHOWN HEREIN WILL BE TENANTS OF THE SHOPPING CENTER
 AT THE LOCATION SHOWN OR AT ANY OTHER LOCATIONS IN THE
 SHOPPING CENTER. GROSS LEASABLE AREA AND PARKING
 INFORMATION SHOWN ALSO IS SUBJECT TO CHANGE AT THE SOLE
 DISCRETION OF THE LANDLORD.

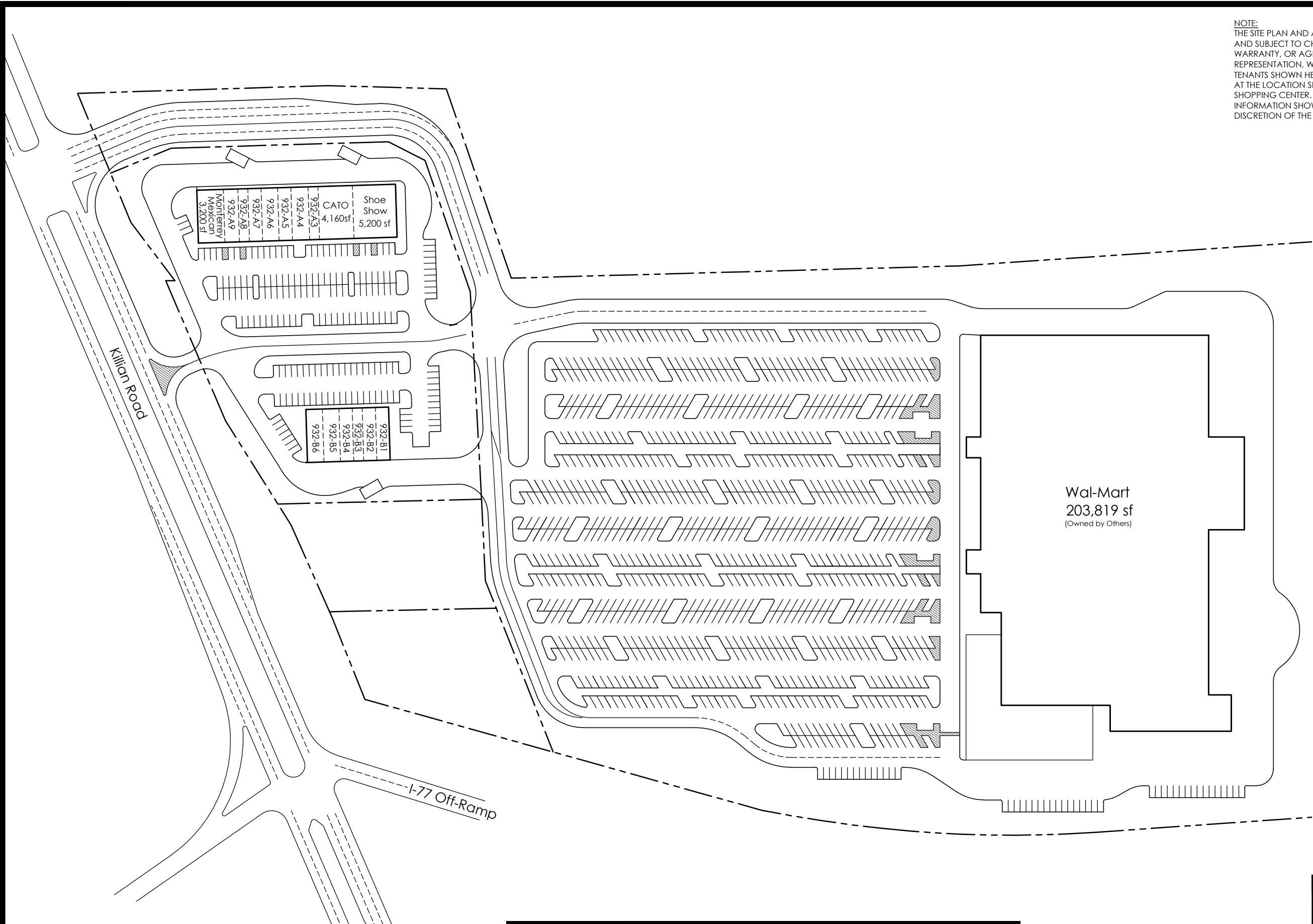

Shop 932-A3	1,200 sf
Shop 932-A4	2,080 sf
Shop 932-A5	1,600 sf
Shop 932-A6	2,000 sf
Shop 932-A7	1,600 sf
Shop 932-A8	1,200 sf
Shop 932-A9	1,760 sf
Shop 932-B1	1,600 sf
Shop 932-B2	1,600 sf
Shop 932-B3	1,200 sf
Shop 932-B4	1,600 sf
Shop 932-B5	4,000 sf
Shop 932-B6	2,000 sf

CATO Shoe Show
 4,160sf 5,200 sf

932-B1
 932-B2
 932-B3
 932-B4
 932-B5
 932-B6

Wal-Mart
 203,819 sf
 (Owned by Others)

Killian Road

I-77 Off-Ramp

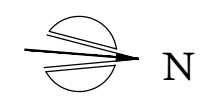

Killian Market Place
 Columbia, South Carolina

